

R-2300 – DAVIDSON COUNTY

NC-8

PROJECT
BREAKDOWN
MAP

PROJECT SCHEDULES AND COSTS ARE ACCURATE AS OF DATE SHOWN

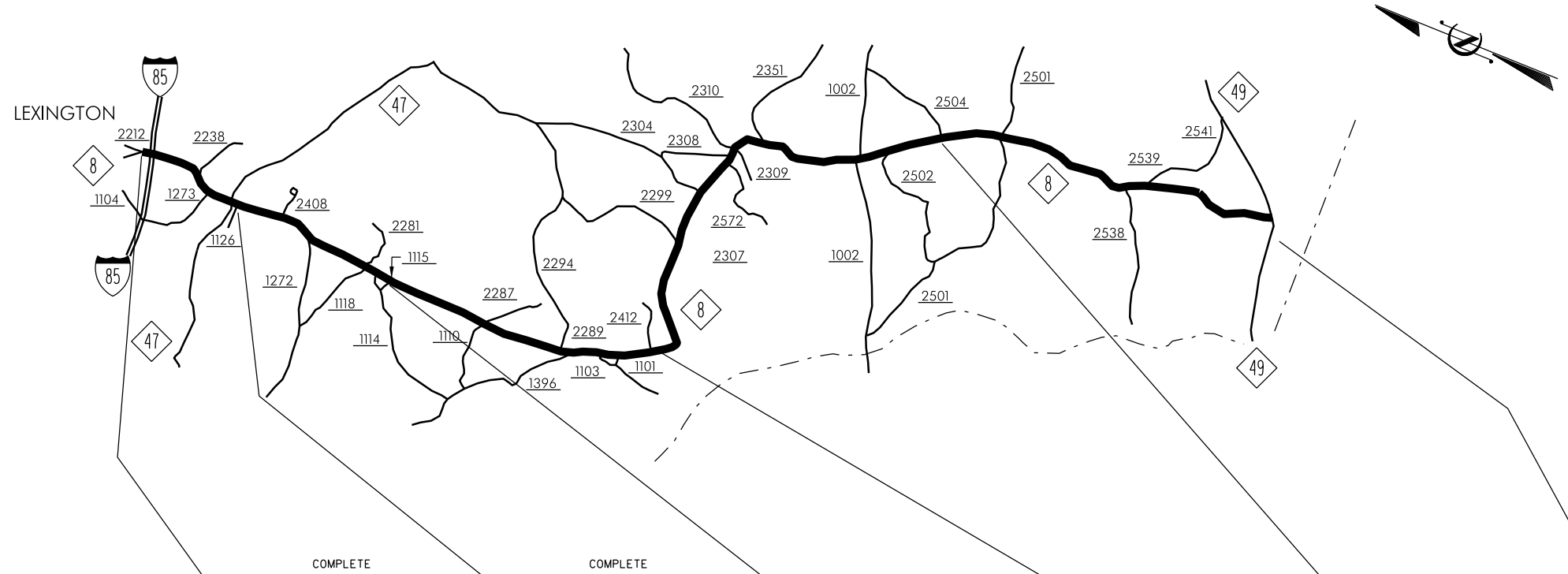

R-2300

	COMPLETE	COMPLETE			
I.D. NO. / D.S.R. NO.	R-2300 BC 344 13	R-2300 BB 344 13	R-2300 BA 344 13	R-2300 AB 344 13	R-2300 AA 344 13
PROJECT ENGINEER	BLEVINS	BLEVINS	J. MOORE	BY DIVISION	BY DIVISION
PROJECT DESCRIPTION	SR 1126 TO SR 22 12	SR 1115 TO SR 1126	SR 2412 TO SR 1115	SR 2504 TO SR 2412	NC 49 TO SR 2504
COUNTY / DIVISION	DAVIDSON / 9	DAVIDSON / 9	DAVIDSON / 9	DAVIDSON / 9	DAVIDSON / 9
LENGTH	1.9 MI.	2.8 MI.	4.5 MI.	8.4 MI.	6.5 MI.
TYPE OF CONTRACT					
REMARKS	WIDEN TO 5 LANES R/W AND CONSTRUCTION PLANS BY PEF	UPGRADE 2 LANES AND WIDEN TO 3 LANES R/W AND CONSTRUCTION PLANS BY PEF	UPGRADE 2 LANES AND WIDEN TO 3 LANES	UPGRADE 2 LANES	UPGRADE 2 LANES
BEGIN R/W ACQUISITION (T.I.P.)	6-98	11-00	PY	PY	PY
BEGIN R/W ACQUISITION (PRODUCTION)					
PROPOSED LETTING (T.I.P.)	12-00	11-02	PY	PY	PY
PROPOSED LETTING (PRODUCTION)					
EST. COMP. DATE (T.I.P.)	5-03	8-05			
ESTIMATED R/W COST	\$ 5,300,000	\$ 10,400,000	\$ 3,250,000	\$ 1,100,000	\$ 550,000
ESTIMATED CONSTRUCTION COST	\$ 7,000,000	\$ 5,500,000	\$ 9,900,000	\$ 10,000,000	\$ 7,400,000