

# R-204 MCDOWELL COUNTY

## PROJECT BREAKDOWN MAP

PROJECT SCHEDULES AND COSTS ARE ACCURATE AS OF DATE SHOWN

I.D. NO. / D.S.R. NO.	COMPLETE R-204 BA
STATE PROJECT NO. (P.E.)	8.1850603
PROJECT ENGINEER	L. SMITH
PROJECT DESCRIPTION	US 221/MARION BYPASS FROM .7 MILES NORTH OF CATAWBA RIVER TO EXISTING US 221/NC 266 INTERSECTION EAST OF MARION
COUNTY / DIVISION	MCDOWELL / 13
LENGTH	6.4 ML.
TYPE OF CONTRACT	PAVING OF B&C
REMARKS	
PROPOSED LETTING (T.I.P.)	5-89
PROPOSED LETTING (PRODUCTION)	
EST. COMP. DATE (T.I.P.)	5-91
ESTIMATED CONSTRUCTION COST	\$ 6,800,000

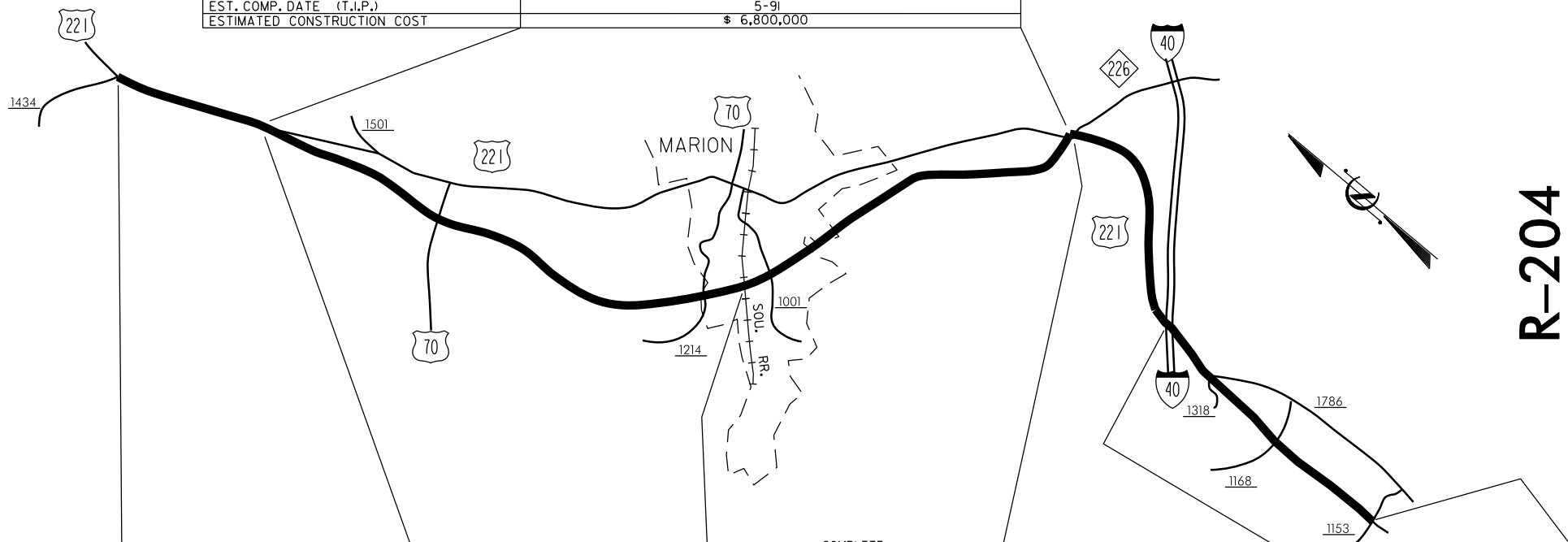

	COMPLETE R-204 A	COMPLETE R-204 B	COMPLETE R-204 C	R-204 D	R-204 E
I.D. NO. / D.S.R. NO.	R-204 A	R-204 B	R-204 C	R-204 D	R-204 E
STATE PROJECT NO. (P.E.) / WBS#	8.1850603	8.1850603	8.1850603	34329	34329
PROJECT ENGINEER	ALFORD / CHAPMAN	L. SMITH	S. STEPNEY	J. MOORE	J. MOORE
PROJECT DESCRIPTION	US 221/NC 226 FROM EXISTING US 221/NC 226 BUS. TO SR 1434	US 221/MARION BYPASS FROM SOUTHERN RAILROAD TO .7 MILE NORTH OF CATAWBA RIVER	US 221/MARION BYPASS FROM US 221-NC 266 INTERSECTION EAST OF MARION TO SOUTHERN RAILROAD	US 221 FROM I-40 TO US 221-NC 226 INTERSECTION	US 221 FROM SR 1153 TO I-40
COUNTY / DIVISION	MCDOWELL / 13	MCDOWELL / 13	MCDOWELL / 13	MCDOWELL / 13	MCDOWELL / 13
LENGTH	1.982 ML.	3.457 ML.	2.93 ML.	1.7 ML.	2.28 ML.
TYPE OF CONTRACT	TURNKEY	GRADING&STRUCTURES	GRADING&STRUCTURES	TURNKEY	TURNKEY
REMARKS			METRIC CONST. INC.		
BEGIN R/W ACQUISITION (T.I.P.)	6-92	8-83	3-81	FY-14	FY-17
BEGIN R/W ACQUISITION (PRODUCTION)					
PROPOSED LETTING (T.I.P.)	1-94	6-87	7-86	FY-16	FY-20
PROPOSED LETTING (PRODUCTION)					
EST. COMP. DATE (T.I.P.)	4-96	8-89	10-88		
ESTIMATED R/W / UTILITY COSTS	\$ 1,983,000	\$ 3,680,000	\$ 2,656,500	\$ 11,700,000	\$ 13,400,000
ESTIMATED CONSTRUCTION COST	\$ 4,000,000	\$ 9,000,000	\$ 5,000,000	\$ 32,500,000	\$ 33,000,000

R-204