

MOUNTING METHOD I

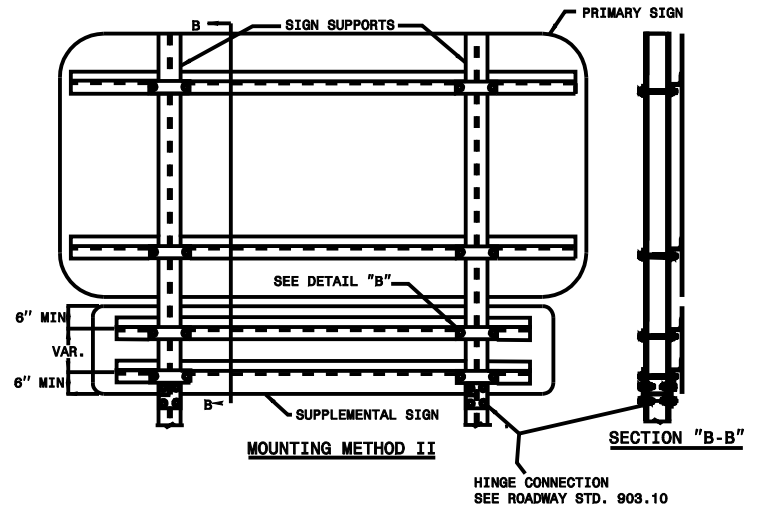

MOUNTING METHOD II

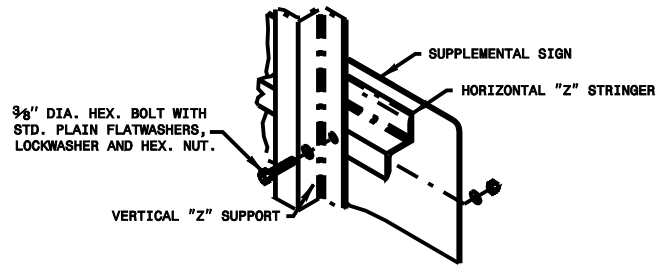

DETAIL "A"
CONNECTION OF HORIZONTAL "Z" STRINGER
AND VERTICAL "Z" SUPPORT.

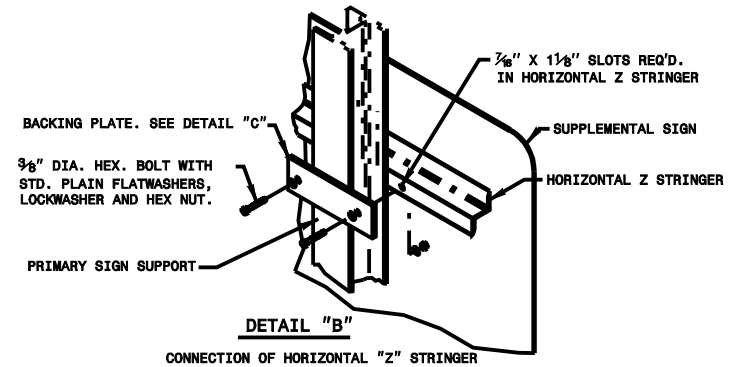

DETAIL "B"
CONNECTION OF HORIZONTAL "Z" STRINGER

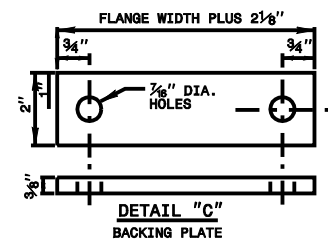

DETAIL "C"
BACKING PLATE

NOTES:

1. FABRICATE VERTICAL AND HORIZONTAL "Z"s OF ALUM. Z 3"x 2-5/16" x 1/4" x 2.33 LB/FT.
2. ATTACH VERTICAL "Z" SUPPORT TO BOTTOM TWO HORIZONTAL STRINGERS ON BACK OF PRIMARY SIGN.
3. SLOTS ARE NOT ALLOWED IN HORIZONTAL STRINGERS FOR ATTACHMENT OF VERTICAL "Z" SUPPORTS.
4. THE HINGE CONNECTION IS LOCATED AT THE BOTTOM OF THE SUPPLEMENTAL PANEL FOR BREAKAWAY SUPPORTS.